

UTN

CARRIERE®  
**MOTIONPRO™**



The New  
Standard in  
Bite Correction

Motion Pro Bite Corrector



## **We've taken fast, predictable, and discreet bite correction from revolutionary to essential.**

Dr. Luis Carrière invented the Motion appliance and popularized the *SAGITTAL FIRST* philosophy. With decades of proven, predictable performance, the *SAGITTAL FIRST* philosophy with Motion appliances provides a time-tested approach that standardizes, simplifies, and shortens Class II and Class III treatment times.

With the Motion Pro Bite Corrector, every surface has been smoothed, every profile lowered, every detail perfected. More than a million confident smiles later with Motion, the path to a new standard is here.



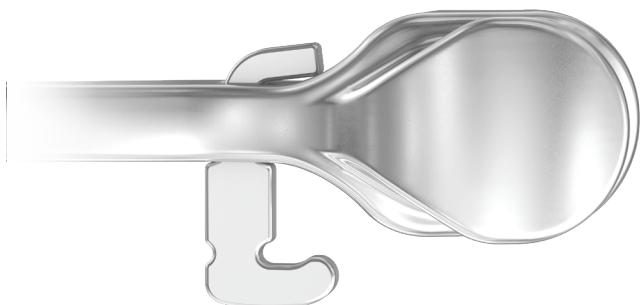

## Intuitive

### Seamless design for improved handling

- Built-in **scribe line**, **flat faces**, **straight edges**, and a **recessed dimple** provide intuitive and accurate placement.
- **Anatomically shaped** molar pad and contoured cuspid pad ensure just the right fit.
- Side-specific design ensures an **optimal range of motion**, allowing precise placement on mesially tipped molars.

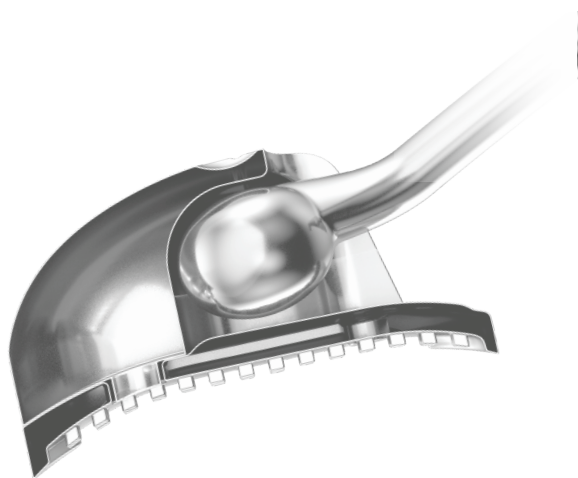

## Versatile

### Engineered to set a new standard in versatility

- Treats both **Class II & III** patients with one device.
- Custom-designed **Drop-In Hook** contributes to a new level of treatment versatility.



## Efficient

### Fast and predictable treatment

- The **condyle shape** moving within the molar base, enhances uprighting and rotation of the molars.
- The **wider reinforced hook** ensures a consistent distribution of elastic forces.
- The **deep undercut** simplifies elastic engagement and effectively secures the new Force 3 Elastics.

# Your Ultimate Solution

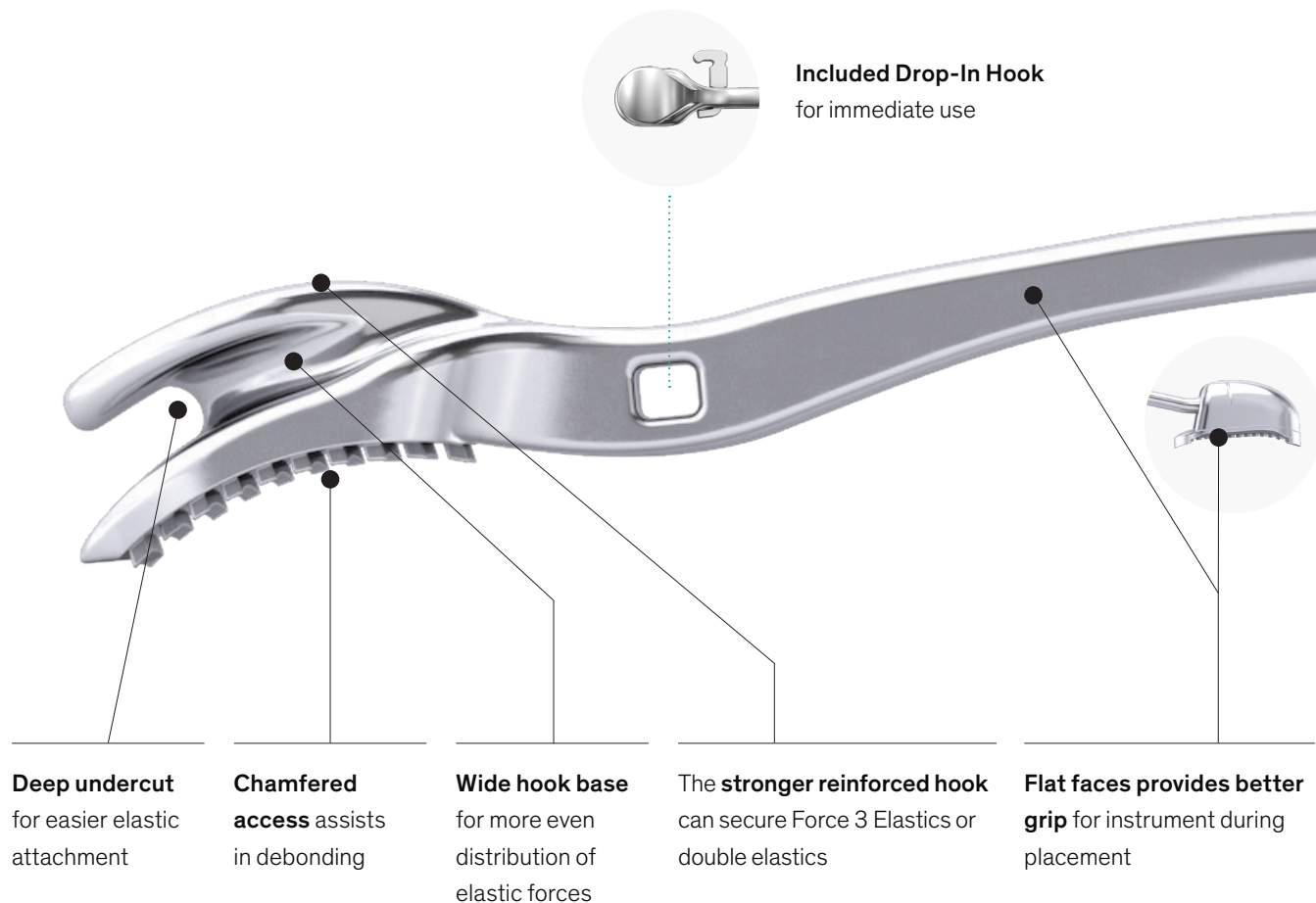

## Included Drop-In Hook



- Custom-designed for the Motion Pro to enhance treatment versatility.
- Facilitates attachment of various orthodontic auxiliaries such as elastomeric chain, nitinol springs, ligature wire, and elastics.
- Designed with a rectangular channel to prevent Drop-In Hook from rotating.

# For Bite Correction

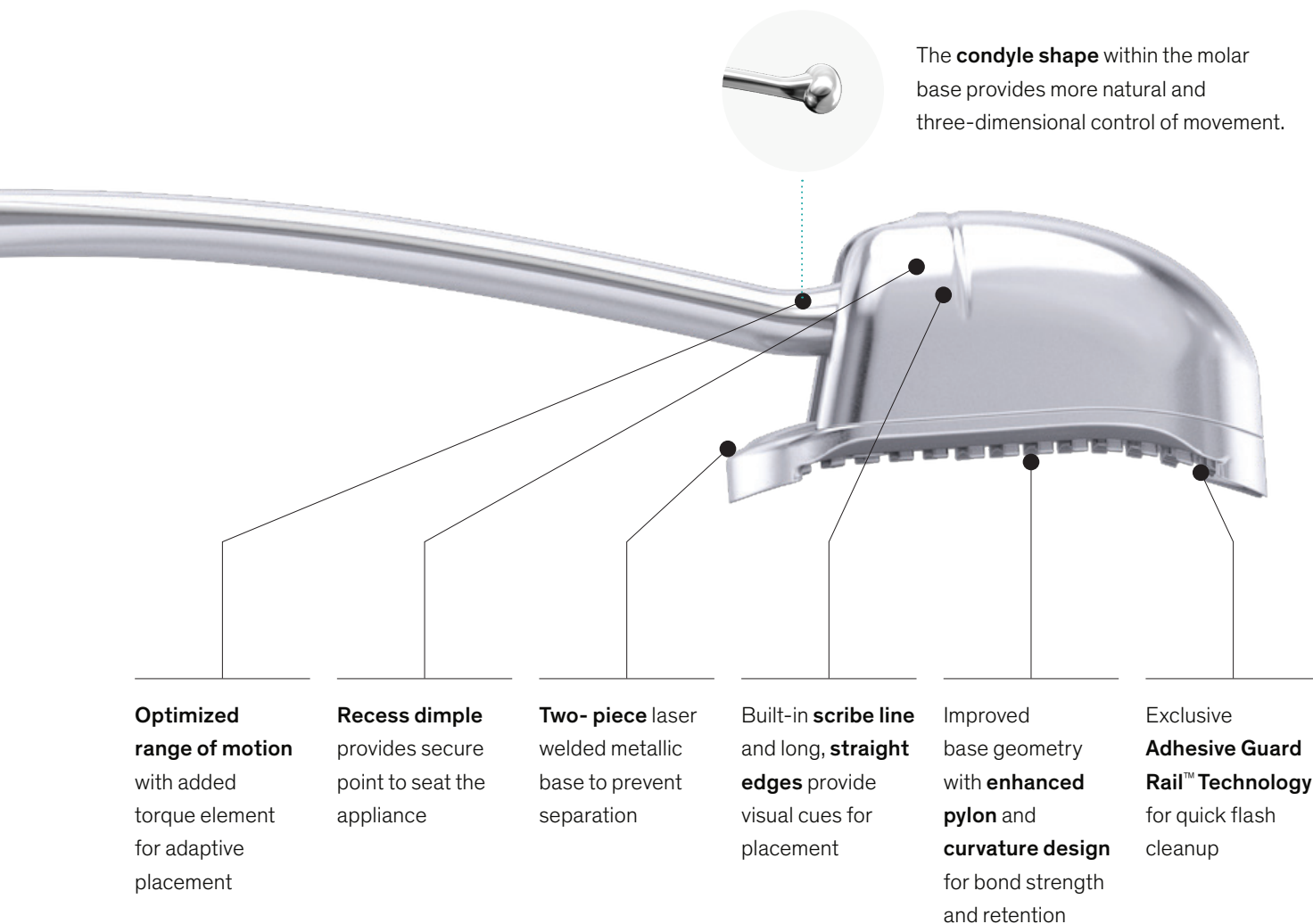

## Importance of a Side-Specific Design

- Its side-specific design ensures the desired range of motion, to **aid in optimized placement on mesially tipped molars**.
- Side-specific features to **prevent over-corrections and unwanted movement**.
- Universal designs still require the same amount of inventory as our side-specific design, as 2 appliances per patient are used!

# Every surface has been smoothed, every profile lowered, every detail perfected.



## 30% Profile Reduction

Lower profile flat base for patient comfort



## Wider

Wider access under hook for easier elastic attachment



## Smooth Surfaces

Full face hook and smooth surfaces make it comfortable for patients to wear, not poking the lips or cheeks



## Ultimate comfort

Lower profile and smooth surface make it comfortable to wear



## Reinforced Flat Hook

Secures even the new, stronger *Carriere Force 3* Elastics, or double elastics when needed



## Shorten Treatment Times

Reduced overall treatment times by standardizing treatments by starting cases from a Class I platform



## Same Day Starts

Takes under 15 minutes to place and can be bonded immediately after the patient consultation



## No Lab Delays

Eliminates lab time delays with direct-bond placement



## The Next Generation



Motion PRO

Motion 3D Metal

Motion 3D Clear

Treats AP dimension at the beginning of treatment



Built-in engineered stops to prevent overcorrection



Simple, direct bond pads



Scribe line on molar base for positioning



Treats Class II & III with one device



—

—

Includes Drop-in Hook for added versatility



—

—

Reinforced flat hook with wider base



—

—

Deep hook undercut for easier elastic attachment



—

—

Condyle-shaped end for more natural and controlled movement



—

—

Optimized range of motion with torque element for adaptive placement



—

—

Recessed dimple provides secure point to seat the appliance



—

—

Long, straight edges for visual cue during placement



—

—

Flat faces for better grip for instrument during placement



—

—

30% reduced profile for patient comfort



—

—

Exclusive Guard Rail Technology for quick flash cleanup



—

—

Two piece laser welded metallic base to prevent separation



—

—

Chamfered access to assist in debonding



—

—



# How Class II Works

## Indications for Class II

- **Class I**, Crowding
- **Class II**, Division 1
- **Class II**, Division 2
- **Class II**, Open bite
- **Class II**, Deep bite
- **Class II**, Blocked out upper cuspids
- **Class II**, Subdivision, left or right (unilateral)
- **Mixed Dentition** (Phase 1)

## Class II Biomechanics

### Before Treatment

1. Excessive overbite
2. Anterior crowding
3. Mesially rotated molars



### During Treatment

Using gentle, uniform forces, Motion Pro achieves ideal Class I occlusion by simultaneously:

- Rotating**  
Rotating the maxillary first molars around the palatal root
- Uprighting**  
Uprighting the maxillary first molars
- Distalizing**  
Distalizing the maxillary posterior segment – from canine or first premolar to first molar, as a unit.

### After Treatment

1. Space is gained to resolve crowding without extractions
2. Molars and cuspids in Class I relationship

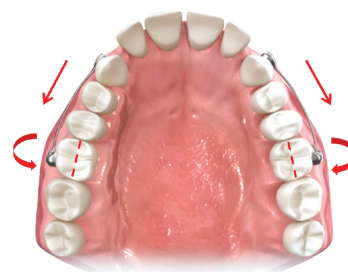

## Setup for Class II Treatment

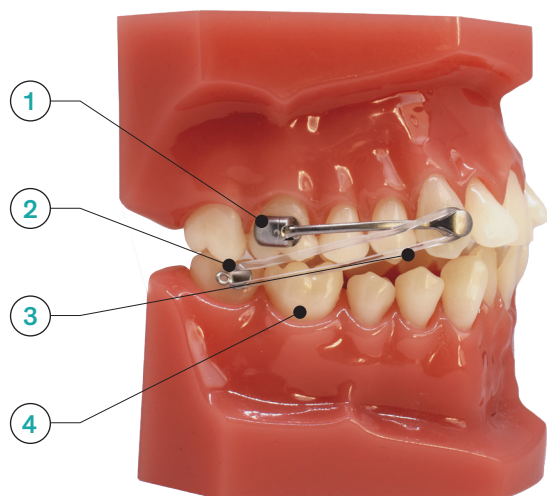

### Step 1

Appliance is bonded from the upper first molar to the canine and first premolar

### Step 2

Bondable hook or molar tube is bonded to the lower first or second molar

### Step 3

Elastics connect the appliance anterior pad to the bondable hook or molar tube

### Step 4

Vacuum-formed retainer, clear aligner, or lingual arch provides anchorage for mandibular arch



# How Class III Works

## Indications for Class III

- Class I, Crowding
- Class III, Deep Bite
- Class III, Open Bite
- Class III, Unilateral
- Class III, Cleft Palate
- Mixed Dentition (Phase 1)
- As an **alternative to surgery**

## Class III Biomechanics

### Before Treatment

1. Excessive underbite
2. FPO
3. Mesially tipped molars



### During Treatment

Counterclockwise change in the occlusal plane by:



#### Intruding

Intruding the lower molars while extruding the canines



#### Distalizing

Distalizing the mandibular posterior segment, from canine to molar, as a unit

### After Treatment

1. Space is gained to resolve crowding without extractions
2. Molars and cuspids in Class I relationship



## Setup for Class III Treatment

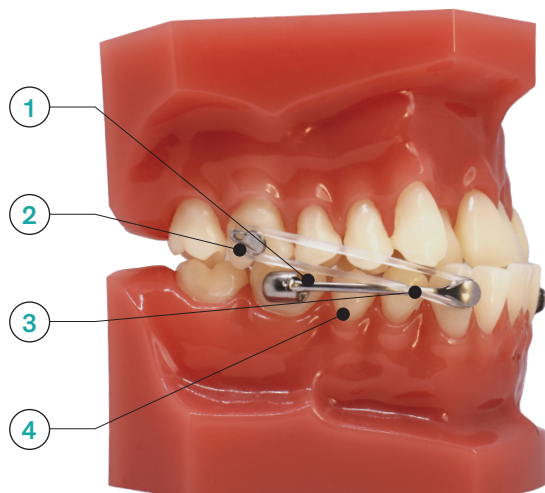

### Step 1

Appliance is bonded from the lower first molar to the canine and first premolar

### Step 2

Bondable hook or molar tube is bonded to the upper first or second molar

### Step 3

Elastics connect the appliance anterior pad to the bondable hook or molar tube

### Step 4

Vacuum-formed retainer, clear aligner, or brackets provide anchorage for maxillary arch



# SAGITTAL FIRST: The Ultimate Success Formula

The *SAGITTAL FIRST* Philosophy is a time-tested approach that standardizes, simplifies, and shortens Class II and Class III treatment times. It employs the Carriere Pro Bite Corrector to treat the AP dimension at the beginning of treatment before placing brackets or aligners. By resolving the most difficult part of treatment first, you can achieve a Class I platform in 3 to 6 months, shortening total treatment time by a minimum of 6 months. You know how excited patients and parents become when you mention shorter treatment times!

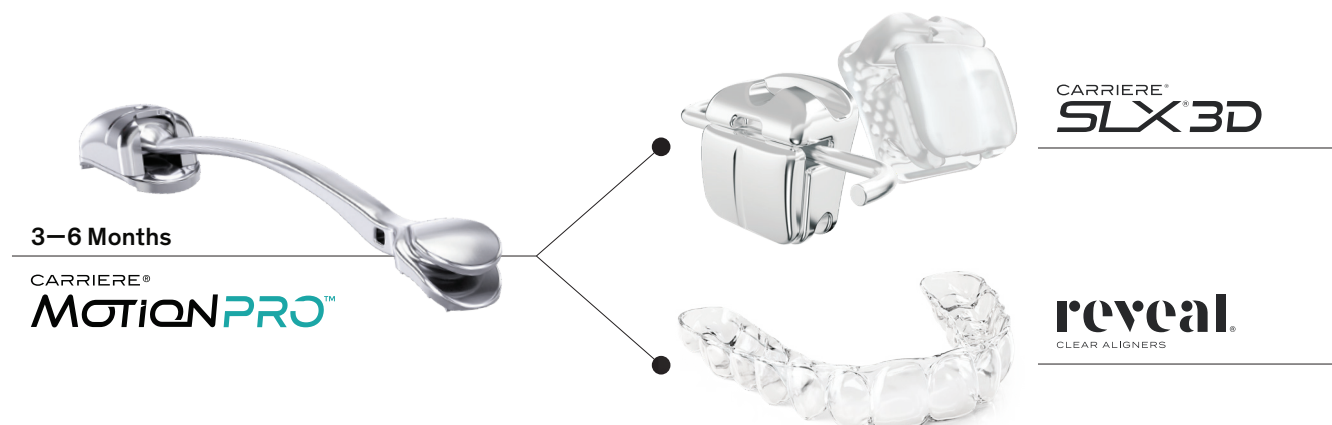

## Benefits of Using SAGITTAL FIRST

### Standardizes and Simplifies Treatment

- Utilizes same treatment protocol no matter the malocclusion type
- Simplifies treatment and planning
- Eliminates lab time delays with direct-bond placement

### Shortens Overall Treatment by up to 6 Months

- Eliminates competing forces associated with AP correction while wearing fixed appliances
- Fosters greater patient compliance at the start of treatment, when patient motivation is highest
- Establishes a Class I platform in 3 to 6 months, faster than any other appliance currently on the market<sup>2</sup>

### Increases Conversion Rates with Same-Day Starts

- Can be bonded immediately after the consultation
- Takes under 15 minutes to place and educate the patient
- Minimize extractions to help build your practice

### More Treatment Options for Patients

- Provides simple bite correction for clear aligner treatment
- Offers opportunity to postpone decision about whether to finish with brackets or aligners based on compliance, hygiene, and treatment progress

# Increase Predictability with Motion Appliances

## Let Motion do the heavy lifting for you!

Reduce complexity and the number of aligners, while shortening treatment times with the Carriere Motion Appliances. Jumpstart your aligner patients with Motion to provide the most efficient and aesthetic treatment solution available.



## Up to 71% fewer aligners with Motion Appliances

	CONVENTIONAL APPROACH WITH ALIGNERS ONLY	SAGITTAL FIRST WITH MOTION PRIOR TO ALIGNERS	% FEWER ALIGNERS
CASE #1	83 Aligners	28 Aligners	66%
CASE #2	45 Aligners	13 Aligners	71%
CASE #3	39 Aligners	21 Aligners	48%



***"By correcting the sagittal first with Motion 3D, I've reduced my number of aligners by an average of 62%! I've improved facial aesthetics, airway and TMJ when needed - in a way that I am not able to do with aligners alone."***

**— Dr. Luis Carrière**

## MOTION PRO ORDERING

### Singles & Sets

DESCRIPTION	SIZE	COLOR CODE	UL/LR	UR/LL	SET			
<i>MOTION Pro</i> Bite Corrector Device 	16 mm	○	425-916ULLR	425-916URLL	425-916C			
	18 mm	●	425-918ULLR	425-918URLL	425-918C			
	20 mm	●	425-920ULLR	425-920URLL	425-920C			
	23 mm	●	425-923ULLR	425-923URLL	425-923C			
	25 mm	●	425-925ULLR	425-925URLL	425-925C			
	27 mm	●	425-927ULLR	425-927URLL	425-927C			
	29 mm	●	425-929ULLR	425-929URLL	425-929C			
	31 mm	●	425-931ULLR	425-931URLL	425-931C			
COLOR CODE	○	●	●	●	●	●	●	●
	White	Blue	Pink	Yellow	Red	Green	Purple	Gray

### Order Recommendations

DESCRIPTION	SET QTY	SIZE	ITEM NO
<i>MOTION Pro</i>	1	23 mm	425-923C
<b>TRIAL SET</b>	1	25 mm	425-925C
	1	27 mm	425-927C
<i>MOTION Pro</i>	1	16 mm	425-916C
<b>INTRO SET</b>	1	18 mm	425-918C
	1	20 mm	425-920C
	1	23 mm	425-923C
	1	25 mm	425-925C
	1	27 mm	425-927C
<i>MOTION Pro</i>	2	16 mm	425-916C
<b>STANDARD SET</b>	3	18 mm	425-918C
	2	20 mm	425-920C
	3	23 mm	425-923C
	6	25 mm	425-925C
	4	27 mm	425-927C

### Motion Pro Ruler

DESCRIPTION	ITEM NO
<i>MOTION Pro</i> Ruler (10/pk)	425-8RULER-10



### Purposeful Packaging

Each Motion Pro device is packaged individually for simplified inventory management.

- Motion Pro is oriented inside the single pack to facilitate direct access with placement instruments.
- Single packs show appliance size and left/right configuration on the outside tab for easier identification and inventory control.
- Single and set packs are simpler, smaller and more elegant, taking up less space in the office.
- Secured with the pull-tab label

## Typodonts & Models

DESCRIPTION	ITEM NO
<b>MOTION Pro Class II Typodont</b> with Clear Aligner	FPO
<b>MOTION Pro Class III Typodont</b> with Clear Aligner	FPO
<b>MOTION Pro 5x Model</b>	631-425X



## Instrument

DESCRIPTION	ITEM NO
<b>MOTION</b> Placement Instrument	201-507

## Carriere Motion Placer

Reverse action tweezers with a spring-action designed open and release around Motion Appliances.

- Notches within tip to securely fit.
- Securely holds without rotating or shifting.



## Sidekick Bondable Hook

Engineered to partner seamlessly with Motion Appliances, the Motion Sidekick™ Bondable Hook further simplifies the SAGITTAL FIRST Philosophy.

- One-piece MIM manufacturing process for exceptional strength.
- Pull extraction access eyelet for versatility during orthodontic treatment.
- Adhesive Guard Rails for easier flash clean up.

## Attachments

DESCRIPTION	ITEM NO
<b>MOTION</b> Sidekick Bondable Hook (pack of 10)	430-003

## FORCE 1, FORCE 2, & FORCE 3 ELASTICS

### All New Force 3 Elastics Now Available

Complement the Motion Pro with Force 1, Force 2, & Force 3 Elastics, which were designed specifically to work seamlessly with this appliance and provide optimum results. These elastics are available in three different force levels for stages of treatment, ensuring a smooth and timely transition to a Class I Platform.

In addition to Force 1 and Force 2 Elastics, doctors now have an alternative to double elastics by using a single Force 3 Elastic (1/4" 11 oz latex elastics).

Box contains 50 packs of 100 Orthodontic Elastics

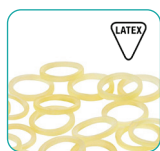

### Latex Elastics

DESCRIPTION	FORCE LVL	BAND	ITEM NO
<b>MOTION FORCE 1</b> Latex Elastics	<b>FORCE 1</b> • 1/4", 6 oz.	Amber	424-9F1
<b>MOTION FORCE 2</b> Latex Elastics	<b>FORCE 2</b> • 3/16", 8 oz.	Amber	424-9F2
<b>MOTION FORCE 3</b> Latex Elastics	<b>FORCE 3</b> • 1/4", 11 oz.	Amber	424-9F3

Made with natural rubber latex



### Non-Latex Elastics

DESCRIPTION	FORCE LVL	BAND	ITEM NO
<b>MOTION FORCE 1</b> Non-Latex Elastics	<b>FORCE 1</b> • 1/4", 6 oz.	Clear	424-8F1
<b>MOTION FORCE 2</b> Non-Latex Elastics	<b>FORCE 2</b> • 3/16", 8 oz.	Clear	424-8F2

Not made with natural rubber latex



We want to help you bring more patients into your office and educate them once they are there!

### Websites

For patients [CarriereConfidence.com](http://CarriereConfidence.com)

**With “Find a Doctor” tool:** As an HSO customer, potential and interested patients can submit a request for an orthodontic professional near them.

For doctors [Marketing Toolkit](#)

**With “Marketing Toolkit”:** Utilize existing logos, product images, videos, model shots, and content for your website, social media, advertising, and more!

1. Visit [HenryScheinOrtho.com/Marketing-Toolkit-Request](http://HenryScheinOrtho.com/Marketing-Toolkit-Request)
2. Request access to Marketing Toolkit (Resources tab -> Marketing Toolkit) and get an access within 2 business days.

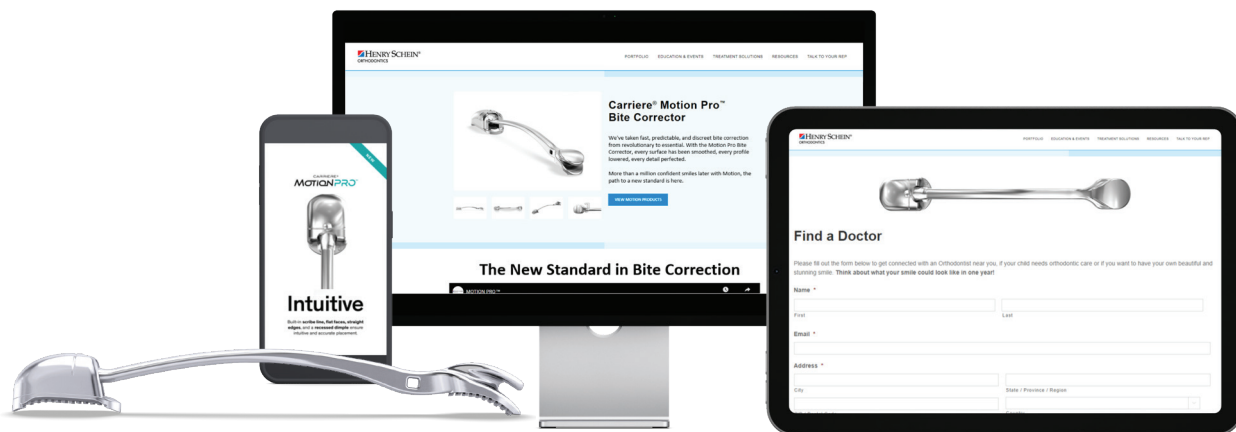

### Brochures, etc.

PATIENT EDUCATION BROCHURES (15/PACK)	ITEM NO
Carriere Motion Pro Patient Brochure	999-357
PRESCRIPTION NOTEPAD (50/PACK)	
Motion Elastic Protocol for Patient	999-518

### Banners

PATIENT BANNER STANDS (32" x 82.87" x 11.2")	ITEM NO
Patient Banner Stand – Surfer Girl	999-341
Patient Banner Stand – Tennis Boy	999-342
Patient Banner Stand – Pedo Girl	999-344



# FIND YOUR PERFECT ORTHODONTIC SOLUTION

Henry Schein® Orthodontics™ aims to deliver next generation orthodontic solutions and new treatment concepts to help you provide exceptional clinical outcomes, and to ensure that you, as an orthodontist, truly love what you do.



## Exceed Your Expectations

Delivering new ideas and treatment concepts to help you provide exceptional clinical outcomes.

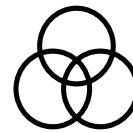

## Beyond the Basics

We go beyond supplier-client relationship to cultivate partnerships with our customers to deliver positive patient outcomes.



## State of the Art

Orthodontic products and solutions enable our customers to offer exceptional patient care.



## World-Class Products

Products you have come to trust we create partnerships with you that go beyond the supplier-client relationship.



רח' הנופר 2, רעננה 4366402 ✉

🌐 [intertec-ortho.com](http://intertec-ortho.com) | ✉ [info@intertec-ortho.com](mailto:info@intertec-ortho.com) | ☎ 09-7419325 | 📞 054-4685150

**Anat Lipnik-Stein**  
[anat@intertec-ortho.com](mailto:anat@intertec-ortho.com)  
054-4454748

**Guy Simon**  
[guy@intertec-ortho.com](mailto:guy@intertec-ortho.com)  
054-5370218

**Liron Itzhak Zion**  
[Liron@intertec-ortho.com](mailto:Liron@intertec-ortho.com)  
054-6877822

**Gali Mor Avni**  
[gali@intertec-ortho.com](mailto:gali@intertec-ortho.com)  
054-4685150